

DATE OF ISSUE:
September 23, 2019

COMMONWEALTH COURT OF THE PENNSYLVANIA
601 COMMONWEALTH AVENUE
HARRISBURG, PENNSYLVANIA

ADDENDUM NO. 01

for

PROJECT NO. CC0P 201901 – CARPET/FLOORING REPLACEMENT
ON THE 3RD, 4TH, AND 5TH FLOORS
OF THE PENNSYLVANIA JUDICIAL CENTER
HARRISBURG, DAUPHIN COUNTY, PENNSYLVANIA

VITETTA, 645 North 12th Street, Suite 100, Lemoyne, PA 17043

BID DATE – MONDAY, SEPTEMBER 30, 2019
TIME OF OPENING – 2:00 PM

This addendum refers to and takes precedence over, clarifies, revised, and/or adds to those
Portions of the drawings and specifications referred to below.

*** Indicates drawing not being re-issued at this time.**

BIDDING AND CONTRACT DOCUMENTS FOR ALL CONTRACTS

BID PROPOSAL

N/A

INSTRUCTIONS TO BIDDERS

N/A

BIDDER QUESTIONS

1. **QUESTION:** A profile detail was requested for the new wood base.
ANSWER: Refer to Detail 02 on Drawing A1.02.

2. **QUESTION:** There is wood base to match in a few rooms. Is the rest vinyl cove? I see no specification for it.
ANSWER: Areas requiring new wood base are covered by the Key Notes on the floor plans. At all other areas without Key Note 3, the existing wood base is to remain. New vinyl base is limited to Files C343 (CCOP's IT Manager Office). The specification for the vinyl base is included in Addendum No. 1 (*refer to Item 12.c*).

3. **QUESTION:** Can you recommend what trade category to be used for flooring mechanics off the prevailing wage list. Would carpet be different from LVT?
ANSWER: Carpenters, Drywall Hangers, Framers, Instrument Men, Lathers, Soft Floor Layers. This covers all three flooring types (carpet, LVT and wood).

4. **QUESTION:** It appears the scale is off on Drawings A2.02 and A2.03. They are shown to be 1/8"=1", but the dimensions work to a 3/16"=1" scale like page A2.01. Please confirm the scale should be 3/16"=1'.
ANSWER: The correct scale is 3/16"=1'-0".

5. **QUESTION:** The specifications state that we are to use a double glue down installation. There is no specification for the padding. Is padding going to be required?
ANSWER: No padding required; therefore, no double glue required.

6. **QUESTION:** Can you confirm what base (wood or vinyl), if any, is to be installed in Files C343, Gathering Room C325, Conference C420 and Kitchen C550.
ANSWER: Files C343: New vinyl base in Files C343 (*refer to Item 12.c*).
Gathering Room C325: Existing wood base to remain. The intent is to slip the new LVT under the wood base once the existing VCT is removed.
Conference C420: Existing wood base to remain.
Kitchen C550: Existing wood base to remain. The intent is to slip the new LVT under the wood base once the existing VCT is removed.

7. **QUESTION:** Please confirm that we will have an entire suite to work on at a time and it will not be room by room.
ANSWER: Yes, an entire suite will be made available. For example, on the north side of the third floor this includes C312, C313, C317, C318 and C319.

8. **QUESTION:** If we get the demolition done in one suite before the new flooring is installed, can we move to another suite and start removal, or must we wait until the other is 100 percent complete?
ANSWER: An entire suite must be completed with all new flooring and base (if required) before moving on to the next suite. The CCOP's intent is that once all suites are complete on a floor, the carpet in the corridor shall be replaced.
9. **QUESTION:** Will parking be provided for contractors?
ANSWER: Parking for contractor vehicles will be made available. Option A is along the delivery ramp on the east side of the building, accessed from 7th Street. Option B is CCOP's spaces along North Street between 7th Street and Commonwealth Avenue. All vehicles must be removed by 7 a.m.

TECHNICAL SPECIFICATIONS

DIVISION 1 – GENERAL REQUIREMENTS

SECTION 010400 – COORDINATION AND CONTROL

10. Page 010400-2: Added Paragraph 1.8.A.3.2 as follows:
- a. Floor protection may remain in place until all work is completed on a particular floor. It does not need to be removed at the end of each work night.
 - 1) Floor protection remaining in place during normal business hours for the Judicial Center must be securely held in place and not create a tripping hazard.

SECTION 096816 – SHEET CARPETING

11. Page 096816-4: Revised Paragraph 3.3.A.1 to read as follows:
- 1. Glue-Down Installation: Comply with CRI 104, Section 13 “Direct Glue Down.”

CHANGES TO DRAWINGS – ALL CONTRACTS

DRAWING A2.01

12. Revision 01, dated September 24, 2019: Added the following Drawing Specific Key Notes.
- a. Demolition Key Note GC-05: General Contractor shall remove, salvage, stack, and palletize the existing carpet tiles being removed and turn them over to the Client Agency, Commonwealth Court, for addition to their attic stock.
 - b. Demolition Key Note GC-06: General Contractor shall remove the existing resilient wall base in preparation for the installation of new resilient wall base.
 - c. Renovation Key Note 13: Provide and install new resilient wall base per the specifications provided below. NO SUBSTITUTIONS.

- | | |
|-------------------------|---|
| 1. Manufacturer | Roppe Corporation, USA |
| 2. Material Requirement | Type TP (Rubber, Thermoplastic) |
| 3. Style | Cover (Base with Toe) |
| 4. Minimum Thickness | 0.125-inch |
| 5. Height | 4-inches |
| 6. Length | Coils in Manufacturer's Standard Length |
| 7. Corners | Pre-Formed |
| 8. Color | 191 Camel |

13. Revision 02, dated September 24, 2019: At Closet 324, corrected floor finish to LVT-1.
14. Revision 03, dated September 24, 2019: At Closet 333, corrected floor finish to WDF-1A.

**PLEASE ACKNOWLEDGE RECEIPT WITHIN 24 HOURS BY COMPLETING BELOW
AND RETURNING VIA EMAIL TO hindermyer@vitetta.com.**

_____	_____	_____
NAME	TITLE	DATE

FIRM

END OF ADDENDUM

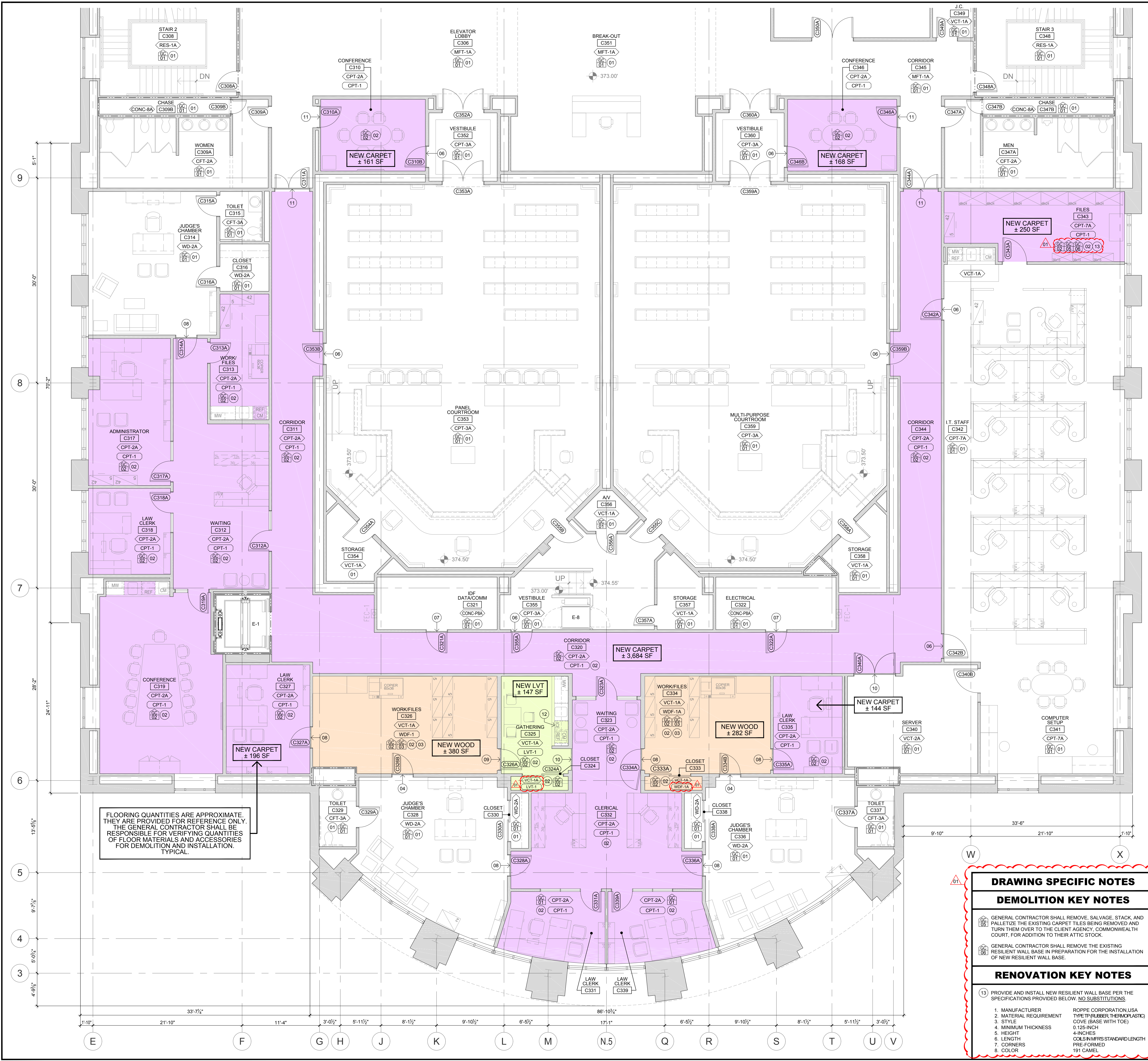

SYMBOLS LEGEND

KEY NOTE FOR FLOOR REMOVAL/DEMOLITION WORK
UPPER LINE INDICATES CONTRACTOR
LOWER LINE INDICATES NOT NUMBER

XXX-# TAG INDICATING EXISTING FLOOR FINISH
REFER TO LIST BELOW FOR ABBREVIATIONS

CFT CERAMIC FLOOR TILE
CONC-P CONCRETE WITH PAINTED FINISH
CPT CARPET
GFT GRANITE FLOOR TILE
RES RESILIENT FLOORING
VCT VINYL COMPOSITION TILE

KEY NOTE FOR RENOVATION/REPLACEMENT WORK
GENERAL CONTRACTOR, UNLESS NOTED OTHERWISE

XXX-# TAG INDICATING REPLACEMENT (NEW FLOOR FINISH
REFER TO LIST ABOVE FOR ABBREVIATIONS

REMOVE EXISTING FLOOR MATERIAL (AS NOTED AT LEFT)
AND
INSTALL NEW CARPET (CPT-1)
REMOVE EXISTING FLOOR MATERIAL (AS NOTED AT LEFT)
AND
INSTALL NEW LUXURY VINYL TILE (LVT-1)
REMOVE EXISTING FLOOR MATERIAL (AS NOTED AT LEFT)
AND
INSTALL NEW WOOD FLOORING (WDF-1)

POCHE COLORS SHOWN ABOVE INDICATE MATERIAL TYPE ONLY.
THEY DO NOT INDICATE FLOORING COLOR, STYLE, PATTERN, ETC.
REFER TO THE TECHNICAL SPECS FOR ADDITIONAL INFORMATION.

DEMOLITION GENERAL NOTES

- THE LAYOUT OF EXISTING LOOSE AND SYSTEMS FURNITURE IS BASED UPON CONTRACT DRAWINGS FROM EARLIER PROJECTS. IT IS SHOWN ON THIS DRAWINGS FOR REFERENCE ONLY. ACTUAL FURNITURE LAYOUT MAY VARY.
- THE EXISTING LOOSE AND SYSTEMS FURNITURE WILL BE REMOVED AND RESET BY THE CLIENT AGENCY.
- FLOORING EXTENDING BENEATH "OPEN" AREAS OF MILLWORK - SUCH AS OPENINGS FOR SINKS, ICE MACHINES, DISHWASHERS, REFRIGERATORS, ETC. - SHALL BE REMOVED.
- THE GENERAL CONTRACTOR SHALL COORDINATE THE REMOVAL AND REPLACEMENT OF WALL BASES, REDUCERS, TRANSITIONS, AND OTHER FLOORING ACCESSORIES WITH THE TECHNICAL SPECIFICATIONS COVERING BOTH DEMOLITION ACTIVITIES AND PROVISION OF NEW FLOORING MATERIALS.
- THE CLIENT AGENCY WILL ARRANGE TO HAVE ALL POWER, DATA, AND SECURITY WIRING TO FURNITURE DISCONNECTED AND RECONNECTED AS NEEDED.

DEMOLITION KEY NOTES

KEY NOTES FOR FLOORING DEMOLITION

NO HATCHING INDICATES SPACES IN WHICH EXISTING FLOOR MATERIALS ARE TO REMAIN. CONTRACTOR SHALL PRESERVE AND PROTECT THESE SURFACES DURING DEMOLITION AND RENOVATION ACTIVITIES.

SOLID HATCHING INDICATES SPACES CONTAINING EXISTING FLOORING MATERIALS TO BE REMOVED AND REPLACED WITH NEW FLOOR MATERIALS UNDER THIS CONTRACT. REFER TO THE SYMBOLS LEGEND (ABOVE) FOR IDENTIFICATION OF MATERIALS.

GENERAL CONTRACTOR SHALL REMOVE THE EXISTING RESILIENT WALL BASE IN PREPARATION FOR THE INSTALLATION OF NEW WOOD WALL BASE.

GENERAL CONTRACTOR SHALL REMOVE THE EXISTING WALL BASE IN PREPARATION FOR INSTALLATION OF NEW WALL BASE AND TURN OVER BASE TO CLIENT AGENCY FOR ATTIC STOCK.

RENOVATION GENERAL NOTES

- THE LAYOUT OF EXISTING LOOSE AND SYSTEMS FURNITURE IS BASED UPON CONTRACT DRAWINGS FROM EARLIER PROJECTS. IT IS SHOWN ON THIS DRAWINGS FOR REFERENCE ONLY. ACTUAL FURNITURE LAYOUT MAY VARY.
- THE EXISTING LOOSE AND SYSTEMS FURNITURE WILL BE REMOVED AND RESET BY THE CLIENT AGENCY.
- FLOORING EXTENDING BENEATH "OPEN" AREAS OF MILLWORK - SUCH AS OPENINGS FOR SINKS, ICE MACHINES, DISHWASHERS, REFRIGERATORS, ETC. - SHALL BE REPLACED WITH NEW.
- THE GENERAL CONTRACTOR SHALL PROVIDE NEW REDUCERS, TRANSITIONS, AND OTHER FLOOR ACCESSORIES AS REQUIRED AT ALL TERMINATION AND TRANSITION POINTS FOR NEW FLOORING MATERIALS. NEW TRANSITIONS, REDUCERS, AND OTHER FLOOR ACCESSORIES SHALL MATCH THE TYPE, MATERIAL, COLOR, ETC., OF THE EXISTING TRANSITIONS.
- REFER TO THE TECHNICAL SPECIFICATIONS FOR INFORMATION REGARDING MANUFACTURER, STYLE, PATTERN, COLOR, ETC., FOR EACH NEW TYPE OF FLOORING MATERIAL.

RENOVATION KEY NOTES

KEY NOTES FOR FLOORING REPLACEMENT RENOVATION WORK

NO HATCHING INDICATES SPACES IN WHICH EXISTING FLOOR MATERIALS ARE TO REMAIN. CONTRACTOR SHALL PRESERVE AND PROTECT THESE SURFACES DURING DEMOLITION AND RENOVATION ACTIVITIES.

SOLID HATCHING INDICATES SPACES CONTAINING EXISTING FLOORING MATERIALS TO BE REMOVED AND REPLACED WITH NEW FLOOR MATERIALS UNDER THIS CONTRACT. REFER TO THE SYMBOLS LEGEND (ABOVE) FOR IDENTIFICATION OF MATERIALS.

A) REFER TO THE TECHNICAL SPECIFICATIONS FOR INFORMATION REGARDING MANUFACTURER, STYLE, PATTERN, COLOR, ETC., FOR EACH NEW TYPE OF NEW FLOORING MATERIAL TO BE PROVIDED.

B) THE HATCHING DOES NOT INDICATE COLOR, PATTERN, DIRECTION, ETC.; IT ONLY INDICATES MATERIAL TYPE.

PROVIDE AND INSTALL NEW WOOD WALL BASE MATCHING THE EXISTING WALL BASE USED THROUGHOUT THE BUILDING. REFER TO DETAIL 02A.02 FOR WALL BASE REQUIREMENTS.

FLOORING TRANSITION - EXISTING WOOD TO NEW WOOD (WDF-1) PROVIDE AND INSTALL NEW THRESHOLD FABRICATED FROM NEW LUXURY VINYL TILE (LVT-1). THRESHOLD SIZE SHALL MATCH WIDTH OF DOOR OPENING + DOOR THICKNESS AND BE CENTERED UNDER THE DOOR.

FLOORING TRANSITION - CARPET TO CERAMIC FLOOR TILE. RETAIN THE EXISTING METAL (SCHLUTER) STRIP AND PREPARE EXISTING SUBSTRATE WITH LEVELING COMPOUND AS REQUIRED TO PROVIDE ALIGN TOP OF CARPET WITH TOP OF MARBLE.

FLOORING TRANSITION - CARPET TO CARPET. NO TRANSITION STRIP IS REQUIRED. PREPARE SUBSTRATE WITH LEVELING COMPOUND AS REQUIRED TO PROVIDE A SMOOTH TRANSITION AT CARPET SEAM.

FLOORING TRANSITION - CARPET TO CONCRETE. PROVIDE AND INSTALL A NEW RESILIENT TRANSITION STRIP. BASIS-OF-DESIGN IS CRS-XX-B AS MFRD BY JOHNSONITE.

FLOORING TRANSITION - CARPET TO WOOD. PROVIDE AND INSTALL A NEW TAPERED WOOD TRANSITION STRIP MATCHING THE WOOD FLOORING.

FLOORING TRANSITION - WOOD TO LUXURY VINYL TILE (LVT) PROVIDE AND INSTALL A NEW RESILIENT TRANSITION STRIP. BASIS-OF-DESIGN IS CRS-XX-A AS MFRD BY JOHNSONITE.

FLOORING TRANSITION - CARPET TO LUXURY VINYL TILE (LVT) OR VINYL COMPOSITION TILE (VCT). PROVIDE AND INSTALL A NEW RESILIENT TRANSITION STRIP. BASIS-OF-DESIGN IS CRS-XX-A AS MFRD BY JOHNSONITE.

FLOORING TRANSITION - CARPET TO MARBLE. RETAIN THE EXISTING METAL (SCHLUTER) STRIP AND PREPARE EXISTING SUBSTRATE WITH LEVELING COMPOUND AS REQUIRED TO PROVIDE ALIGN TOP OF CARPET WITH TOP OF MARBLE.

NEW FLOORING MATERIAL SHALL EXTEND INTO OPEN APPLIANCE BAY BENEATH COLUMN. TEMPORARILY RELOCATE ICE MAKER AND/OR REFRIGERATOR AS NEEDED.

DRAWING SPECIFIC NOTES

DEMOLITION KEY NOTES

GENERAL CONTRACTOR SHALL REMOVE, SALVAGE, STACK, AND PALLETIZE THE EXISTING CARPET TILES BEING REMOVED AND TURN THEM OVER TO THE CLIENT AGENCY, COMMONWEALTH COURT, FOR ADDITION TO THEIR ATTIC STOCK.

GENERAL CONTRACTOR SHALL REMOVE THE EXISTING RESILIENT WALL BASE IN PREPARATION FOR THE INSTALLATION OF NEW RESILIENT WALL BASE.

RENOVATION KEY NOTES

PROVIDE AND INSTALL NEW RESILIENT WALL BASE PER THE SPECIFICATIONS PROVIDED BELOW. NO SUBSTITUTIONS.

1. MANUFACTURER	ROPPE CORPORATION USA
2. MATERIAL REQUIREMENT	TYPE IV (RUBBER/THERMOPLASTIC) COVE (BASE WITH TOE)
3. STYLE	1
4. MINIMUM THICKNESS	4-INCHES
5. HEIGHT	COLS IN MFRS STANDARD LENGTH
6. LENGTH	191 CAMEL
7. CORNERS	
8. COLOR	

VITETTA

ARCHITECTURE ENGINEERING PLANNING INTERIOR DESIGN
BALDWIN TOWER 1510 CHESTER PIKE, STE 104
EDDYSTONE, PENNSYLVANIA 15022
615 NORTH 12TH STREET SUITE 100
LEWISBURG, PENNSYLVANIA 17043
717.283.1165 F 717.754.0558

APPROXIMATE WORK AREA
3RD FLOOR
4TH FLOOR
5TH FLOOR

BUILDING NORTH
PENNSYLVANIA JUDICIAL CENTER
PROFESSIONAL'S SEAL

PROJECT 4613.0800
ALL DIMENSIONS MUST BE VERIFIED BY CONTRACTOR AND THE ARCHITECT NOTIFIED OF ANY DISCREPANCIES BEFORE PROCEEDING WITH THE CONSTRUCTION.
DO NOT SCALE DRAWINGS
© 2019 VITETTA
PROJECT TITLE

FLOORING REPLACEMENT ON LEVELS 3, 4, AND 5
AT THE
PENNSYLVANIA JUDICIAL CENTER
601 COMMONWEALTH AVENUE
HARRISBURG, PENNSYLVANIA 17120
COMMONWEALTH COURT OF PENNSYLVANIA

DRAWING TITLE
ARCHITECTURAL
THIRD FLOOR
PART C
FLOOR REPLACEMENT

SCALE 3/16" = 1'-0" (UNLESS NOTED OTHERWISE)

DRAWN	J. JOIN
CHECKED	D. VOZDZAK
APPROVED	D. VOZDZAK
DATE	09.09.2019 BID SET

REVISIONS

NUMBER	DATE	DESCRIPTION
01	09.23.2019	ADDENDUM 01
02		
03		
04		
05		
06		

DRAWING

A2.01